

A

B

C

D

E

F

G

H

TFK-280SA-22125 MOTOR

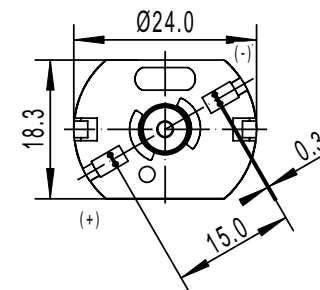
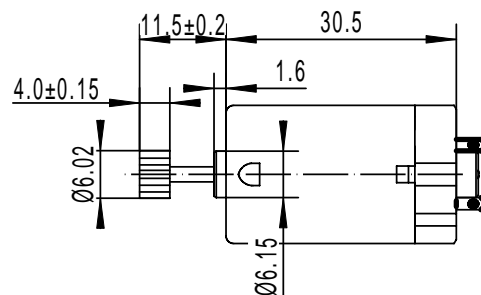
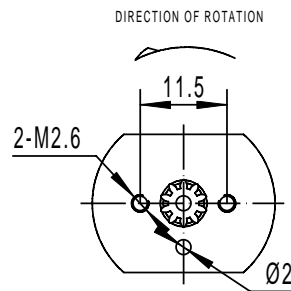

MOTOR Specification

Operating voltage: 6.0V DC

- 1、 No Load Speed:7500±10%rpm
- 2、 No Load Current:90mA (120mA max)
- 3、 30g.cm Load Speed:6100rpm
- 4、 Stall Torque:150g.cm min
- 5、 Stall Current:2.6A (3.2A MAX)

| | |
|------------------|------------|
| Pressure Angle | 20° |
| Number Of TEETH | 10 |
| PITCH | 0.5 Module |
| Outside Diameter | 6.02 |

| | | | |
|----------------------------------|------------------|------------------------|----------------------------------|
| TITLE:TFK-280SA-22125 | Customer No: | Drafted By: Kevin wang | |
| Dwg. NO: bm22125-002 | Date: 2015.06.15 | Checked By: | |
| TT MOTOR (HK) INDUSTRIAL CO.,LTD | | Scale: 1:1 | Units: mm |
| | | EDITION No: A | Angular: =1° Decimal: X.XX ±0.05 |
| | | | X.X ±0.2 |
| | | | X ±0.3 |